

MANIFOLD CHECK VALVE VALAN-20A

Description

These valves are connected between the discharge hose and the manifold, allows the gas flow in one direction only, from the hose to the manifold, not in the other way.

The valves prevent gas from escaping from the piping system during a discharge (except, of course, into the protected hazard area), should a cylinder not be connected to the manifold. They are supplied from the factory screwed onto the manifold.

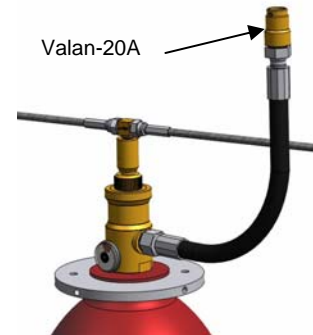
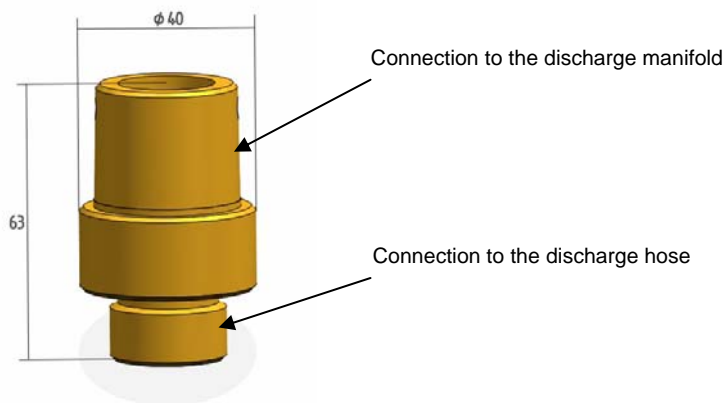

Technical Information

VALAN-20A	
Body VALAN-20A	Brass CuZn40Pb2
Connection to the manifold	1" NPT
Connection to the discharge hose	3/4" BSP
Minimum opening pressure	1 bar
Approvals	UL-EX15547 FM-3053302

WARNING: This type of manifold check valve VALAN-20A, are manufactured and approved to be used in fixed extinguishing installations with FM-200®. This product is not designed for other use or purpose. If product user has any doubt regarding the application or product use, please contact +34 947 28 11 08. Every not approved use or application or / and any other not approved modification of the product or its function may cause serious accidents or / and personal damages. SIEX 2001 S.L. is not responsible for any non-approved use of the application.

IMPORTANT: SIEX 2001 S.L. reserves the right to change or modify without previous notice any data or specification due to changes or modification in order to improve the products presented.

FM-200® is a registered Trademark of DuPont used under license by SIEX 2001 S. L